



HAMMERS

**Ram
mer®**

RAMMER HITS FIRST

The world's best-known and most-respected brand of hydraulic hammers offers a comprehensive range of powerful, productive and durable attachments that are suitable for carriers in the 0.6 to 100 tons operating weight class.

Divided into four hydraulic hammer families, the Rammer hydraulic hammer range is unsurpassed in its innovation and reliability and offers class-leading power-to-weight characteristics that mark them as the best in their class.

These hammers, which incorporate many key design features invented by Sandvik, are supported by a dedicated global dealer network with ready access to Genuine Rammer parts and a wealth of operational knowledge and experience to ensure that your Rammer hammer continues to contribute to your company's profitability for its entire working life.





CONTENT

COMPACT RANGE

108 8-9

211 8-9

315 8-9

522 8-9

SMALL RANGE

111 12-13

222 12-13

333 12-13

555 14-15

777 14-15

999 14-15

MEDIUM RANGE

1533 .. 18-19

2155 .. 18-19

LARGE RANGE

2577 .. 22-23

3288 .. 22-23

4099 .. 22-23

4510 .. 24-25

4511 .. 24-25

7013 .. 24-25

PARTS AND TOOLS

.. 26-27

COMPACT RANGE

| Model | Working weight, kg (lb) | Impact rate, bpm | Operating pressure, bar (psi) |
|------------|----------------------------|---------------------|----------------------------------|
| 108 | 70-80 (150-180) | 400-1900 | 100-140 (1450-2030) |
| 211 | 100-115 (220-250) | 400-1900 | 100-140 (1450-2030) |
| 315 | 135-155 (300-340) | 400-1900 | 100-140 (1450-2030) |
| 522 | 205-235 (450-520) | 400-1900 | 110-150 (1595-2175) |

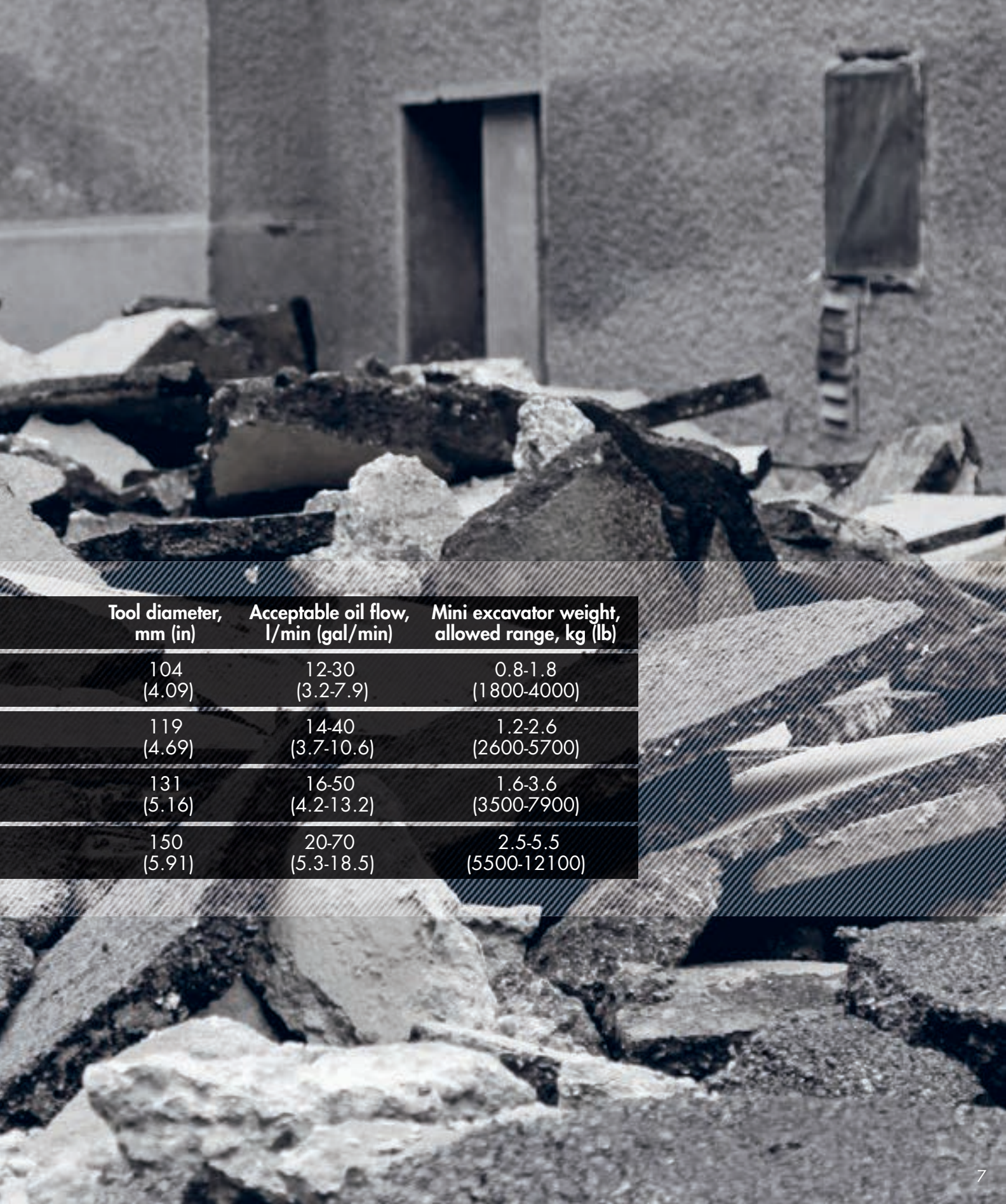

| Tool diameter, mm (in) | Acceptable oil flow, l/min (gal/min) | Mini excavator weight, allowed range, kg (lb) |
|-----------------------------------|---|--|
| 104 (4.09) | 12-30 (3.2-7.9) | 0.8-1.8 (1800-4000) |
| 119 (4.69) | 14-40 (3.7-10.6) | 1.2-2.6 (2600-5700) |
| 131 (5.16) | 16-50 (4.2-13.2) | 1.6-3.6 (3500-7900) |
| 150 (5.91) | 20-70 (5.3-18.5) | 2.5-5.5 (5500-12100) |

108**211****315****522**

FEATURES

- Plug and play
- Mounting either as pin-on or with mounting bracket
- Unbreakable tool
- Wide oil flow range
- Composite bushing-no greasing needed
- Twin-handed
- Membrane type accumulator
- CBE (Constant Blow Energy)
- No tie rods
- Protected hose connection

BENEFITS

- Easy to use and service
- Easy to install
- Broad carrier range
- Low operating costs
- Excellent fit for rental
- High reliability
- Constant high productivity



| | 108 | 211 |
|---|---------------------|---------------------|
| Working weight, kg [lb] (1) | 70-80 (150-180) | 100-115 (220-250) |
| Impact rate, bpm | 400-1900 | 400-1900 |
| Operating pressure, bar [psi] | 100-140 (1450-2030) | 100-140 (1450-2030) |
| Pressure relief, min, bar [psi] (2) | 150 (2175) | 150 (2175) |
| Pressure relief, max, bar [psi] | 220 (3190) | 220 (3190) |
| Oil flow range, l/min [gal/min] | 12-30 (3.2-7.9) | 14-40 (3.7-10.6) |
| Back pressure, max, bar [psi] | 20 (290) | 20 (290) |
| Input power, kW [hp] | 7.0 (9) | 9.3 (12) |
| Tool diameter, mm [in] | 104 (4.09) | 119 (4.69) |
| Mini excavator weight, optimum range t [lb] (3) | 1.0-1.5 (2200-3300) | 1.5-2.1 (3300-4600) |
| Mini excavator weight, allowed range t [lb] (3) | 0.8-1.8 (1800-4000) | 1.2-2.6 (2600-5700) |
| Skid steer, robot weight, optimum range, t [lb] (3) | 0.7-1.0 (1500-2200) | 1.0-1.4 (2200-3100) |
| Skid steer, robot weight, allowed range, t [lb] (3) | 0.5-1.3 (1100-2900) | 0.8-1.8 (1800-4000) |
| Noise level, measured sound power level, LWA, dB(A) (4) | 129 | 127 |
| Noise level, guaranteed sound power level, LWA, dB(A) (4) | 133 | 131 |

(1) Depending on mounting configuration (2) Minimum setting = actual operating pressure + 50 bar or (+ 725 psi) (3) Check carrier allowed attachment weight from carrier manufacturer. Check application requirements (4) According to European Union DIRECTIVE 2000/14/EC



| | 315 | 522 |
|---|---------------------|----------------------|
| Working weight, kg (lb) [1] | 135-155 (300-340) | 205-235 (450-520) |
| Impact rate, bpm | 400-1900 | 400-1900 |
| Operating pressure, bar (psi) | 100-140 (1450-2030) | 110-150 (1595-2175) |
| Pressure relief, min, bar (psi) [2] | 150 (2175) | 160 (2320) |
| Pressure relief, max, bar (psi) | 220 (3190) | 220 (3190) |
| Oil flow range, l/min (gal/min) | 16-50 (4.2-13.2) | 20-70 (5.3-18.5) |
| Back pressure, max, bar (psi) | 20 (290) | 20 (290) |
| Input power, kW (hp) | 11.7 (16) | 17.5 (23) |
| Tool diameter, mm (in) | 131 (5.16) | 150 (5.91) |
| Mini excavator weight, optimum range t (lb) [3] | 2.0-2.9 (4400-6400) | 2.9-4.2 (6400-9300) |
| Mini excavator weight, allowed range t (lb) [3] | 1.6-3.6 (3500-7900) | 2.5-5.5 (5500-12100) |
| Skid steer, robot weight, optimum range, t (lb) [3] | 1.3-1.9 (2900-4200) | 1.9-2.8 (4200-6200) |
| Skid steer, robot weight, allowed range, t (lb) [3] | 1.1-2.5 (2400-5500) | 1.6-3.9 (3500-8600) |
| Noise level, measured sound power level, LWA, dB(A) [4] | 128 | 133 |
| Noise level, guaranteed sound power level, LWA, dB(A) [4] | 132 | 137 |

[1] Depending on mounting configuration [2] Minimum setting = actual operating pressure + 50 bar or (+ 725 psi) [3] Check carrier allowed attachment weight from carrier manufacturer. Check application requirements [4] According to European Union DIRECTIVE 2000/14/EC

SMALL RANGE

| Model | Working weight, kg (lb) | Impact rate, bpm | Operating pressure, bar (psi) |
|------------|----------------------------|---------------------|----------------------------------|
| 111 | 70 (150) | 1000-2600 | 80-130 (1160-1885) |
| 222 | 105 (230) | 1100-2600 | 100-150 (1450-2175) |
| 333 | 150 (330) | 1050-2050 | 100-150 (1450-2175) |
| 555 | 275 (610) | 600-1800 | 90-140 (1305-2030) |
| 777 | 370 (820) | 500-1700 | 90-140 (1305-2030) |
| 999 | 505 (1110) | 500-1700 | 100-140 (1450-2030) |

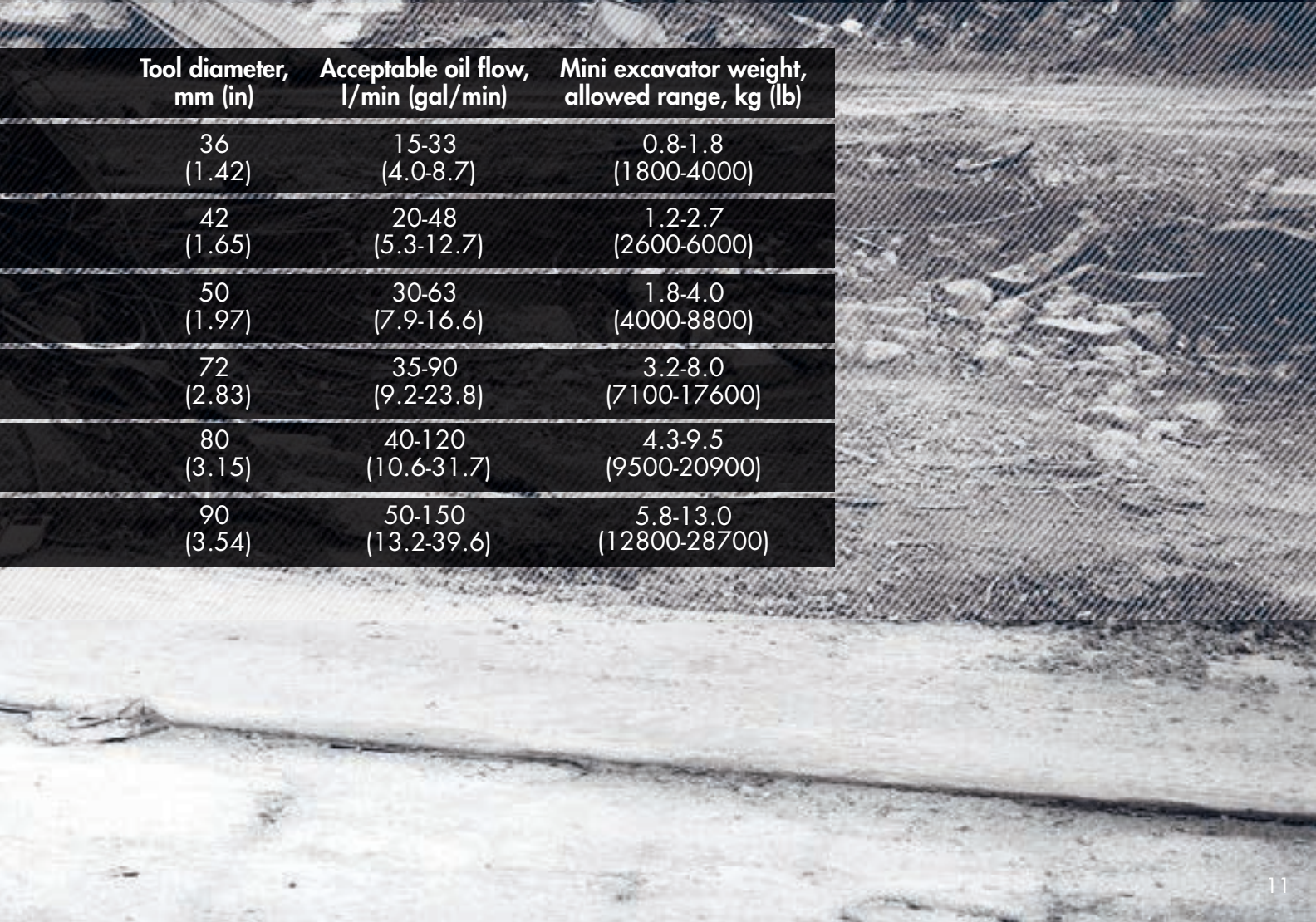

| Tool diameter, mm (in) | Acceptable oil flow, l/min (gal/min) | Mini excavator weight, allowed range, kg (lb) |
|-----------------------------------|---|--|
| 36 (1.42) | 15-33 (4.0-8.7) | 0.8-1.8 (1800-4000) |
| 42 (1.65) | 20-48 (5.3-12.7) | 1.2-2.7 (2600-6000) |
| 50 (1.97) | 30-63 (7.9-16.6) | 1.8-4.0 (4000-8800) |
| 72 (2.83) | 35-90 (9.2-23.8) | 3.2-8.0 (7100-17600) |
| 80 (3.15) | 40-120 (10.6-31.7) | 4.3-9.5 (9500-20900) |
| 90 (3.54) | 50-150 (13.2-39.6) | 5.8-13.0 (12800-28700) |

111**222****333**

FEATURES

- Streamlined shape
- Single tool bushing
- Simple tool installation
- Membrane type accumulator
- High frequency
- FBE (Fixed Blow Energy)
- PRS (Pressure Release System)
- No tie rods

BENEFITS

- Able to work in narrow spaces
- Fast and easy service
- Low operating costs

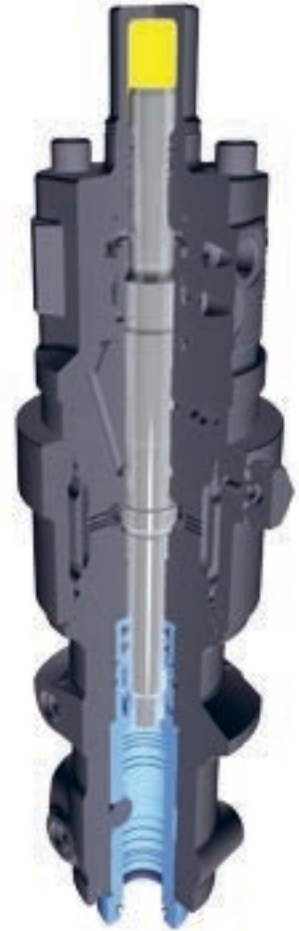
**111**

| | |
|---|----------------------|
| Working weight, kg (lb) (1) | 70 (150) |
| Impact rate, bpm | 1000-2600 |
| Operating pressure, bar (psi) | 80-130 (1160-1885) |
| Pressure relief, min, bar (psi) (2) | 130-180 (1885-2610) |
| Pressure relief, max, bar (psi) | 220 (3190) |
| Oil flow range, l/min (gal/min) | 15-33 (4.0-8.7) |
| Back pressure, max, bar (psi) | 20 (290) |
| Input power, kW (hp) | 7.15 (10) |
| Tool diameter, mm (in) | 36 (1.42) |
| Mini excavator weight, optimum range, t (lb) (3) | 1.0-1.5 (2200-3300) |
| Mini excavator weight, allowed range, t (lb) (3) | 0.8-1.8 (1800-4000) |
| Skid steer, robot weight, optimum range, t (lb) (3) | 0.7-1.0 (1500- 2200) |
| Skid steer, robot weight, allowed range, t (lb) (3) | 0.6-1.3 (1300-1700) |
| Noise level, measured sound power level, LWA, dB(A) (4) | 117 |
| Noise level, guaranteed sound power level, LWA, dB(A) (4) | 121 |

(1) Depending on mounting configuration (2) Minimum setting = actual operating pressure + 50 bar or (+ 725 psi) (3) Check carrier allowed attachment weight from carrier manufacturer. Check application requirements (4) According to European Union DIRECTIVE 2000/14/EC



| | 222 | 333 |
|---|---------------------|---------------------|
| Working weight, kg (lb) (1) | 105 (230) | 150 (330) |
| Impact rate, bpm | 1100-2600 | 1050-2050 |
| Operating pressure, bar (psi) | 100-150 (1450-2175) | 100-150 (1450-2175) |
| Pressure relief, min, bar (psi) (2) | 150-200 (2175-2900) | 150-200 (2175-2900) |
| Pressure relief, max, bar (psi) | 220 (3190) | 220 (3190) |
| Oil flow range, l/min (gal/min) | 20-48 (5.3-12.7) | 30-63 (7.9-16.6) |
| Back pressure, max, bar (psi) | 20 (290) | 20 (290) |
| Input power, kW (hp) | 12 (16) | 15.75 (21) |
| Tool diameter, mm (in) | 42 (1.65) | 50 (1.97) |
| Mini excavator weight, optimum range, t (lb) (3) | 1.4-2.2 (3100-4900) | 2.0-3.2 (4400-7100) |
| Mini excavator weight, allowed range, t (lb) (3) | 1.2-2.7 (2600-6000) | 1.8-4.0 (4000-8800) |
| Skid steer, robot weight, optimum range, t (lb) (3) | 0.9-1.5 (2000-3300) | 1.3-2.1 (2860-4630) |
| Skid steer, robot weight, allowed range, t (lb) (3) | 0.8-1.8 (1800-4000) | 1.2-2.7 (2600-6000) |
| Noise level, measured sound power level, LWA, dB(A) (4) | 123 | 119 |
| Noise level, guaranteed sound power level, LWA, dB(A) (4) | 127 | 123 |

(1) Depending on mounting configuration (2) Minimum setting = actual operating pressure + 50 bar or (+ 725 psi) (3) Check carrier allowed attachment weight from carrier manufacturer. Check application requirements (4) According to European Union DIRECTIVE 2000/14/EC

555**777****999**

FEATURES

- Single body design
- Simple tool installation
- Sealed housing design
- High frequency
- Wide oil flow range
- Membrane type accumulator
- Twin-handed hose connection
- Protected hose connection
- Sound suppressed
- No tie rods
- CBE+ (Constant Blow Energy plus)

BENEFITS

- Easy to use and service
- Low operating costs
- Broad carrier range
- High reliability
- Constant high productivity



555

| | |
|---|----------------------|
| Working weight, kg (lb) [1] | 275 (610) |
| Impact rate, bpm | 600-1800 |
| Operating pressure, bar (psi) | 90-140 (1305-2030) |
| Pressure relief, min, bar (psi) [2] | 140-200 (2030-2900) |
| Pressure relief, max, bar (psi) | 220 (3190) |
| Oil flow range, l/min (gal/min) | 35-90 (9.2-23.8) |
| Back pressure, max, bar (psi) | 20 (290) |
| Input power, kW (hp) | 21 (28) |
| Tool diameter, mm (in) | 72 (2.83) |
| Mini excavator, tractor backhoe weight, optimum range, t (lb) [3] | 3.6-5.8 (7940-12800) |
| Mini excavator, tractor backhoe weight, allowed range, t (lb) [3] | 3.2-8.0 (7100-17600) |
| Skid steer, robot weight, optimum range, t (lb) [3] | 2.4-3.9 (5300-8600) |
| Skid steer, robot weight, allowed range, t (lb) [3] | 1.9-5.3 (4200-11700) |
| Noise level, measured sound power level, LWA, dB(A) [4] | 118 |
| Noise level, guaranteed sound power level, LWA, dB(A) [4] | 122 |

[1] Depending on mounting configuration [2] Minimum setting = actual operating pressure + 50 bar or (+ 725 psi) [3] Check carrier allowed attachment weight from carrier manufacturer. Check application requirements [4] According to European Union DIRECTIVE 2000/14/EC



| | 777 | 999 |
|---|-----------------------|------------------------|
| Working weight, kg (lb) [1] | 370 (820) | 505 (1110) |
| Impact rate, bpm | 500-1700 | 500-1700 |
| Operating pressure, bar (psi) | 90-140 (1305-2030) | 100-140 (1450-2030) |
| Pressure relief, min, bar (psi) [2] | 140-190 (2030-2755) | 150-190 (2175-2755) |
| Pressure relief, max, bar (psi) | 220 (3190) | 220 (3190) |
| Oil flow range, l/min (gal/min) | 40-120 (10.6-31.7) | 50-150 (13.2-39.6) |
| Back pressure, max, bar (psi) | 20 (290) | 20 (290) |
| Input power, kW (hp) | 28 (38) | 35 (47) |
| Tool diameter, mm (in) | 80 (3.15) | 90 (3.54) |
| Mini excavator, tractor backhoe weight, optimum range, t (lb) [3] | 4.9-7.8 (10800-17200) | 6.6-10.6 (14600-23400) |
| Mini excavator, tractor backhoe weight, allowed range, t (lb) [3] | 4.3-9.5 (9500-20900) | 5.8-13.0 (12800-28700) |
| Skid steer, robot weight, optimum range, t (lb) [3] | 3.3-5.2 (7300-11500) | 4.4-7.1 (9700-15700) |
| Skid steer, robot weight, allowed range, t (lb) [3] | 2.6-6.3 (5700-13900) | 3.9-8.7 (8600-19200) |
| Noise level, measured sound power level, LWA, dB(A) [4] | 120 | 123 |
| Noise level, guaranteed sound power level, LWA, dB(A) [4] | 124 | 127 |

[1] Depending on mounting configuration [2] Minimum setting = actual operating pressure + 50 bar or (+ 725 psi) [3] Check carrier allowed attachment weight from carrier manufacturer. Check application requirements [4] According to European Union DIRECTIVE 2000/14/EC

MEDIUM RANGE

| Model | Working weight, kg (lb) | Impact rate, bpm | Operating pressure, bar (psi) |
|-------------|----------------------------|---------------------|----------------------------------|
| 1533 | 870 (1920) | 550-1050 | 140-160 (2030-2320) |
| 2155 | 1220-1255 (2690-2770) | 490-780 | 140-160 (2030-2320) |



| Tool diameter, mm (in) | Acceptable oil flow, l/min (gal/min) | Carrier weight, allowed range, t (lb) |
|-----------------------------------|---|--|
| 105 (4.13) | 80-140 (21.1-37.0) | 10-19 (22000-41900) |
| 118 (4.65) | 120-180 (31.7-47.6) | 16-26 (35300-57300) |

1533**2155**

FEATURES

- Lifetime Warranty
- Slim and light design
- Membrane type accumulator
- Twin-handed
- Sound suppressed
- VIDAT tie rods
- FBE (Fixed blow energy)
- Safety valve (Optional)
- Ramlube I (Optional)
- Ramlube III (Optional)
- Heavy duty set (Optional)
- Integrated HD hoses and couplings

BENEFITS

- Safe capital investment
- Good access to narrow places
- Constant high productivity
- Low operating costs
- Easy and safe installation
- High reliability
- Constant high productivity



1533

| | |
|--|---------------------|
| Working weight, kg (lb) (1) | 870 (1920) |
| Impact rate, bpm | 550-1050 |
| Operating pressure, bar (psi) | 140-160 (2030-2320) |
| Pressure relief, min, bar (psi) (2) | 220 (3190) |
| Pressure relief, max, bar (psi) | 240 (3480) |
| Oil flow range, l/min (gal/min) | 80-140 (21.1-37.0) |
| Back pressure, max, bar (psi) | 10 (145) |
| Input power, kW (hp) | 37 (50) |
| Tool diameter, mm (in) | 105 (4.13) |
| Carrier weight, optimum range, t (lb) (3) | 11-17 (24300-37500) |
| Carrier weight, allowed range, t (lb) (3) | 10-19 (22000-41900) |
| Noise level, measured sound power level, [WA, dB(A)] (4) | 120 |
| Noise level, guaranteed sound power level, [WA, dB(A)] (4) | 124 |

(1) Depending on mounting configuration (2) Minimum setting = actual operating pressure + 50 bar or (+ 725 psi) (3) Check carrier allowed attachment weight from carrier manufacturer. Check application requirements (4) According to European Union DIRECTIVE 2000/14/EC



2155

| | |
|---|-----------------------|
| Working weight, kg (lb) (1) | 1220-1255 (2690-2770) |
| Impact rate, bpm | 490-780 |
| Operating pressure, bar (psi) | 140-160 (2030-2320) |
| Pressure relief, min, bar (psi) (2) | 220 (3190) |
| Pressure relief, max, bar (psi) | 240 (3480) |
| Oil flow range, l/min (gal/min) | 120-180 (31.7-47.6) |
| Back pressure, max, bar (psi) | 10 (145) |
| Input power, kW (hp) | 48 (64) |
| Tool diameter, mm (in) | 118 (4.65) |
| Carrier weight, optimum range, t (lb) (3) | 19-22 (41900-48500) |
| Carrier weight, allowed range, t (lb) (3) | 16-26 (35300-57300) |
| Noise level, measured sound power level, LWA, dB(A) (4) | 124 |
| Noise level, guaranteed sound power level, LWA, dB(A) (4) | 128 |

(1) Depending on mounting configuration (2) Minimum setting = actual operating pressure + 50 bar or (+ 725 psi) (3) Check carrier allowed attachment weight from carrier manufacturer. Check application requirements (4) According to European Union DIRECTIVE 2000/14/EC

LARGE RANGE

| Model | Working weight, kg (lb) | Impact rate, bpm, Long/Short stroke | Operating pressure, bar (psi) |
|-------------|----------------------------|--|----------------------------------|
| 2577 | 1760 (3880) | 450-750 | 135-145 (1960-2105) |
| 3288 | 2330-2350 (5140-5180) | 370-630/ 460-740 | 150-160 (2175-2320) |
| 4099 | 3380-3540 (7450-7800) | 400-560/ 520-700 | 150-160 (2175-2320) |
| 4510 | 3800 (8380) | 350-550 | 155-165 (2250-2395) |
| 4511 | 3800 (8380) | 300-480 | 140-155 (2030-2250) |
| 7013 | 7000 (15432) | 350-450 | 150-170 (2175-2465) |

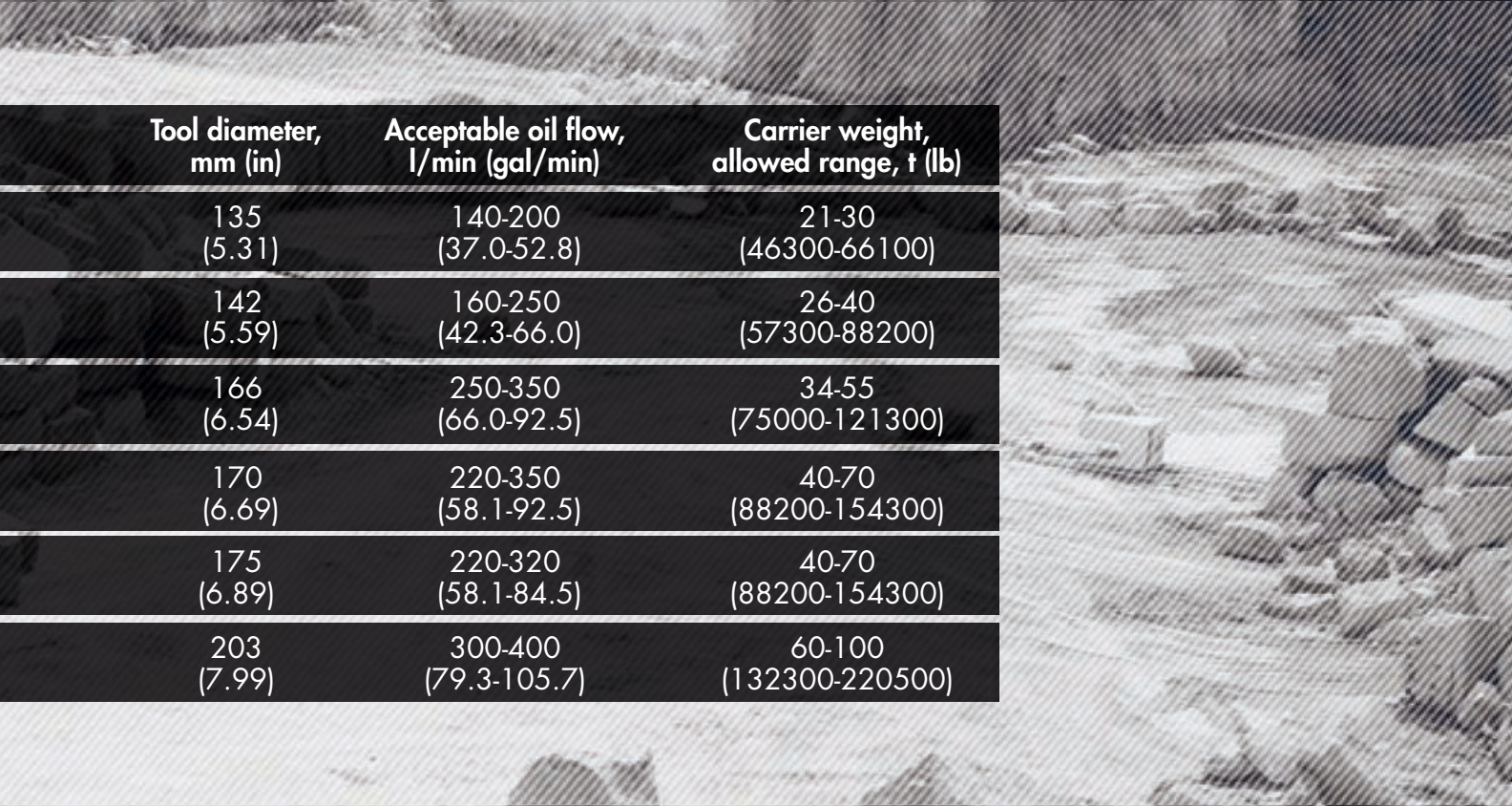

| Tool diameter, mm (in) | Acceptable oil flow, l/min (gal/min) | Carrier weight, allowed range, t (lb) |
|-----------------------------------|---|--|
| 135 (5.31) | 140-200 (37.0-52.8) | 21-30 (46300-66100) |
| 142 (5.59) | 160-250 (42.3-66.0) | 26-40 (57300-88200) |
| 166 (6.54) | 250-350 (66.0-92.5) | 34-55 (75000-121300) |
| 170 (6.69) | 220-350 (58.1-92.5) | 40-70 (88200-154300) |
| 175 (6.89) | 220-320 (58.1-84.5) | 40-70 (88200-154300) |
| 203 (7.99) | 300-400 (79.3-105.7) | 60-100 (132300-220500) |

2577**3288****4099**

FEATURES

- Lifetime Warranty
- Membrane type accumulator
- Twin-handed (Indexable power cell)
- Sound suppressed
- VIDAT tie rods
- FBE (Fixed blow energy)
- Ramlube I (Optional)
- Ramlube II (Optional)
- Heavy duty housing
- Idle blow protector, Selection on/off
- Stroke selector, Selection long/short (3288, 4099)
- Safety valve (2577)
- Soft blow sensor (2577)
- Ramdata II (3288, 4099)

BENEFITS

- Safe capital investment
- Constant high productivity
- Easy and safe installation
- Low operating costs
- High reliability



2577

| | |
|---|---------------------|
| Working weight, kg (lb) [1] | 1760 (3880) |
| Impact rate, bpm | 450-750 |
| Operating pressure, bar (psi) | 135-145 (1960-2105) |
| Pressure relief, min, bar (psi) [2] | 190 (2755) |
| Pressure relief, max, bar (psi) | 220 (3190) |
| Oil flow range, l/min (gal/min) | 140-200 (37.0-52.8) |
| Back pressure, max, bar (psi) | 10 (145) |
| Input power, kW (hp) | 48 (64) |
| Tool diameter, mm (in) | 135 (5.31) |
| Carrier weight, optimum range, t (lb) [3] | 23-28 (50700-61700) |
| Carrier weight, allowed range, t (lb) [3] | 21-30 (46300-66100) |
| Noise level, measured sound power level, LWA, dB(A) [4] | 120 |
| Noise level, guaranteed sound power level, LWA, dB(A) [4] | 124 |

[1] Depending on mounting configuration [2] Minimum setting = actual operating pressure + 50 bar or (+ 725 psi) [3] Check carrier allowed attachment weight from carrier manufacturer. Check application requirements [4] According to European Union DIRECTIVE 2000/14/EC



| | 3288 | 4099 |
|---|-----------------------|-----------------------|
| Working weight, kg (lb) [1] | 2330-2350 (5140-5180) | 3380-3540 (7450-7800) |
| Impact rate, Long stroke, bpm | 370-630 | 400-560 |
| Impact rate, Short stroke, bpm | 460-740 | 520-700 |
| Operating pressure, bar (psi) | 150-160 (2175-2320) | 150-160 (2175-2320) |
| Pressure relief, min, bar (psi) [2] | 220 (3190) | 210 (3045) |
| Pressure relief, max, bar (psi) | 240 (3480) | 230 (3335) |
| Oil flow range, l/min (gal/min) | 160-250 (42.3-66.0) | 250-350 (66.0-92.5) |
| Back pressure, max, bar (psi) | 10 (145) | 12 (175) |
| Input power, kW (hp) | 67 (90) | 93 (125) |
| Tool diameter, mm (in) | 142 (5.59) | 166 (6.54) |
| Carrier weight, optimum range, t (lb) [3] | 28-38 (61700-83800) | 37-50 (81600-110200) |
| Carrier weight, allowed range, t (lb) [3] | 26-40 (57300-88200) | 34-55 (75000-121300) |
| Noise level, measured sound power level, LWA, dB(A) [4] | 124 | 126 |
| Noise level, guaranteed sound power level, LWA, dB(A) [4] | 128 | 130 |

[1] Depending on mounting configuration [2] Minimum setting = actual operating pressure + 50 bar or (+ 725 psi) [3] Check carrier allowed attachment weight from carrier manufacturer. Check application requirements [4] According to European Union DIRECTIVE 2000/14/EC

4510**4511****7013**

FEATURES

- Membrane type accumulator
- Sound suppressed
- FBE (Fixed blow energy)
- Ramlube I (Optional)
- Ramlube II (Optional)
- Dust suppression (Optional)
- Heavy duty housing

BENEFITS

- Low operating costs
- High reliability
- Constant high productivity

| | 4510 |
|---|----------------------|
| Working weight, kg (lb) [1] | 3800 (8380) |
| Impact rate, bpm | 350-550 |
| Operating pressure, bar (psi) | 155-165 (2250-2395) |
| Pressure relief, min, bar (psi) [2] | 205 (2975) |
| Pressure relief, max, bar (psi) | 230 (3335) |
| Oil flow range, l/min (gal/min) | 220-350 (58.1-92.5) |
| Back pressure, max, bar (psi) | 10 (145) |
| Input power, kW (hp) | 96 (129) |
| Tool diameter, mm (in) | 170 (6.69) |
| Carrier weight, optimum range, t (lb) [3] | 44-65 (97000-143300) |
| Carrier weight, allowed range, t (lb) [3] | 40-70 (88200-154300) |
| Noise level, measured sound power level, LWA, dB(A) [4] | 123 |
| Noise level, guaranteed sound power level, LWA, dB(A) [4] | 127 |

[1] Depending on mounting configuration [2] Minimum setting = actual operating pressure + 50 bar or (+ 725 psi) [3] Check carrier allowed attachment weight from carrier manufacturer. Check application requirements [4] According to European Union DIRECTIVE 2000/14/EC



| | 4511 | 7013 |
|---|----------------------|------------------------|
| Working weight, kg (lb) [1] | 3800 (8380) | 7000 (15430) |
| Impact rate, bpm | 300-480 | 350-450 |
| Operating pressure, bar (psi) | 140-155 (2030-2250) | 150-170 (2175-2465) |
| Pressure relief, min, bar (psi) [2] | 195 (2830) | 220 (3190) |
| Pressure relief, max, bar (psi) | 220 (3190) | 230 (3335) |
| Oil flow range, l/min (gal/min) | 220-320 (58.1-84.5) | 300-400 (79.3-105.7) |
| Back pressure, max, bar (psi) | 8 (115) | 10 (145) |
| Input power, kW (hp) | 83 (111) | 113 (152) |
| Tool diameter, mm (in) | 175 (6.89) | 203 (7.99) |
| Carrier weight, optimum range, t (lb) [3] | 44-65 (97000-143300) | 65-95 (143300-209400) |
| Carrier weight, allowed range, t (lb) [3] | 40-70 (88200-154300) | 60-100 (132300-220500) |
| Noise level, measured sound power level, LWA, dB(A) [4] | 125 | 125 |
| Noise level, guaranteed sound power level, LWA, dB(A) [4] | 129 | 129 |

[1] Depending on mounting configuration [2] Minimum setting = actual operating pressure + 50 bar or (+ 725 psi) [3] Check carrier allowed attachment weight from carrier manufacturer. Check application requirements [4] According to European Union DIRECTIVE 2000/14/EC

For sales and service, contact your Allied Distributor:



3900 Kelley Avenue, Cleveland, Ohio 44114
Tel: 216-431-2600 Fax: 216-431-2601
e-mail: Sales@AlliedCP.com
website: <http://www.AlliedCP.com>