

Reliability in Action

LG938L



SDLG2219297





# LG938L Wheel Loader

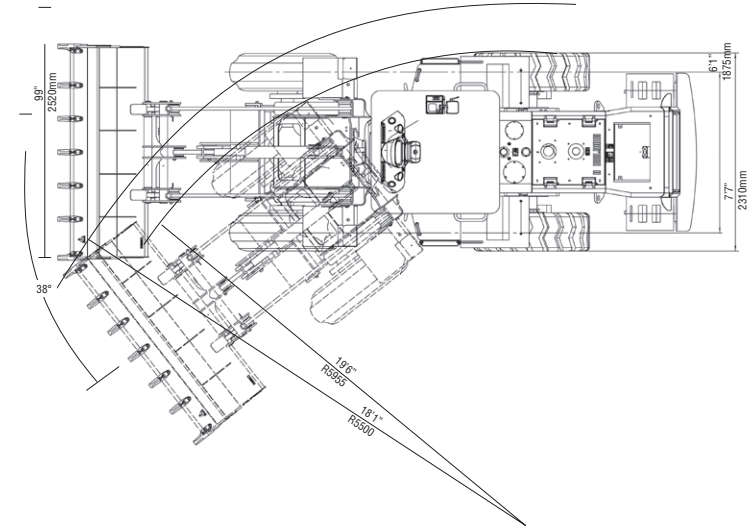
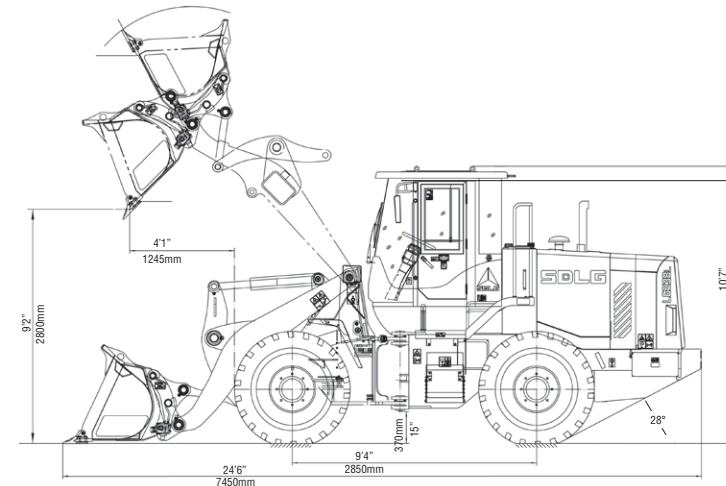

## LG938L Standard Features

- Deutz 6.1 liter, tier 4i-certified engine with reversible cooling fan
- ZF 4WG158 powershift transmission
- SDLG dry disc brakes on all 4 wheels
- Air conditioned operator cab with AM/FM radio and USB interface
- Cab is ROPS / FOPS - ISO EN 3449, ISO EN 3471, ISO EN 3164
- Single lever control with separate third function
- Hydraulic quick coupler - ISO Interface - in cab actuation switch
- Full powered third function hydraulics
- General purpose bucket - 2.4 yd<sup>3</sup> (1.8 m<sup>3</sup>) with bolt-on edge
- 12 Month/1500 hour warranty (conditions apply)

## Optional Equipment

- Long Boom
- Boom Suspension System
- 17.5R25 L3 tubeless tires (radial)
- Light Material Bucket - 3.3 yd<sup>3</sup> (2.5 m<sup>3</sup>) with bolt on edge
- Quick attach fork lift frame with 49" fork tines

Specifications Brief		
Max Power, 2200 rpm	160 hp	120 kW
Max Torque, 1450 rpm	530 lbf-ft	720 Nm
Bucket Capacity	2.4 yd <sup>3</sup>	1.8 m <sup>3</sup>
Rated Load	6,000 lbs	2,720 kg
Full Turn Tipping Load	14,860 lbs	6,740 kg
Breakout Force	16,410 lbf	73.0 kN
Rimpull	20,345 lbf	90.5 kN
Operating Weight	23,150 lbs	10,500 kg

Rated load with standard bucket & arm with hydraulic quick coupler

Specifications are subject to change without prior notice from SDLG North America in line with the continuous improvement program from SDLG

Engine	
Model	Deutz TCD6.1L6 Tier 4i
Type	6 cyl., 4-Stroke, turbocharged, water-cooled, high-pressure common rail fuel injection system
Max Gross Power, 2200 rpm	160 hp 120 kW
Max Net Power, 2200 rpm	142 hp 106 kW
Max Torque, 1450 rpm	530 lbf-ft 720 Nm
Displacement	372 in <sup>3</sup> 6.1 l

Drivetrain				
Type	Countershaft			
	Gear	Forward	Reverse	
Travel Speed	1st	4.3 mph, 7.0 kph		
	2nd	7.1 mph, 11.5 kph		
	3rd	14.1 mph, 22.7 kph		
	4th	22.6 mph, 36.4 kph		
Torque Converter	Type	3 Elements, Single Phase, Single Turbine, Hydraulic Converter		
	Torque Multiplication	2.9		
	Oil Inlet Pressure	123 PSI	0.85 MPa	
	Oil Outlet Pressure	73 PSI	0.5 MPa	
Transmission: ZF 4WG158	Type	Electric Over Hydraulic Powershift		
	Pump	Internal Gear Pump		
	Working Pressure	232 - 261 PSI	1.6 - 1.8 PSI	
	Transmission Ratio	Forward, 1st	3.996	
		Forward, 2nd	2.368	
		Forward, 3rd	1.126	
		Forward, 4th	0.626	
		Reverse, 1st	3.996	
		Reverse, 2nd	2.368	
	Axles	Main Drive	Type	Single-Stage, Spiral Bevel
Final Drive		Type	Single-Stage, Planetary	
Tires	Type	17.5-25 16-Ply Tubeless		
		Tire Pressure	Front	49.0 PSI, 0.34 MPa
Brakes	Service Brake	Hydraulically actuated, dry disc brakes on all 4 wheels		
	Parking Brake	Mechanically Operated, Hydraulic Release		
	Brake Oil Pressure	1500 PSI	10.3 MPa	

Steering System	
Type	Load sensing, fully hydraulic articulated steering
Steering Pump	Gear Driven Hydraulic Pump
Steering Pressure	2031 PSI 14.0 MPa
Steering Flow	53.0 gpm 202.0 lpm
Steering Cylinders: Cylinder Bore x Piston Rod Diameter x Stroke	Double Acting 80 x 40 x 327 mm 3.1" x 1.8" x 12.9"

Hydraulic System	
Type	Single Lever Control with Separate Third Function
Main System Pump	Gear Driven Hydraulic Pump
System Pressure	2031 PSI 16.0 MPa
System Flow	66.0 gpm 250.0 lpm
Boom Cylinder: Cylinder Bore X Piston Rod Diameter X Stroke	Double Acting 125 x 70 x 771 mm 4.9" x 2.8" x 30.3"
Bucket Cylinder: Cylinder Bore x Piston Rod Diameter x Stroke	Double Acting 140 x 80 x 502 mm 5.5" x 3.1" x 19.7"
Lift Time, Loaded	≤5.6 s
Dump Time, Empty	≤0.89 s
Lower Time, Empty	≤3.85 s
Total Time	≤10.34 s

Electrical System	
Voltage	24.0 V
Batteries	2 X 12 V
Battery Capacity	120.0 Ah
Cold Cranking Amps	850.0 CCA
Alternator Rating	2400 W, 100 A
Starter Motor Output	4.0 kW

Service	
Fuel Tank	37.0 gal 140.0 l
Hydraulic Oil Tank	33.8 gal 128.0 l
Engine Oil	4.0 gal 15.0 l
Engine Coolant	7.9 gal 30.0 l
Main Drive, Axle	4.8 gal 18.0 l
Final Drive, Axle	4.8 gal 18.0 l
Transmission	9.2 gal 35.0 l